

# ADCOCK

R E A L E S T A T E



## 143 Leslie Road Lenswood SA

8 🏠 3 🚗 5 🚘

Plant vines, graze cattle, rest extended family in the 3-bed cottage, or champion what 'The Pavilions' has just metres away - luxury guest stays - on a serene farm canvas encompassing dual-living potential and spectacular views in a very special setting?

With each dwelling staged to admire the uplifting terrain of soaring hillsides, bordering roses, mature stringybarks and the winter creek; the property creates infinite ways to prosper with 5 paddocks on its radar; even an old dairy.

Perhaps the dream is farming. There's arable land and stock yards, a redgum plantation, small orchard, and large high clearance shedding for tools and farm equipment and toys; all assisted by extensive water catchment infrastructure thanks to hefty rainwater tanks, creeks, 2 bores, kilometres of interconnecting pipes and hydrants

**Price** : \$ 1,825,000  
**Land Size** : 24.99 ha  
**View** : <https://www.adcock.com.au/7821944>



**Andrew Adcock**  
08 8388 4777



**Nikki Seppelt**  
08 8388 4777



(NOT IN ACTUAL POSITION)

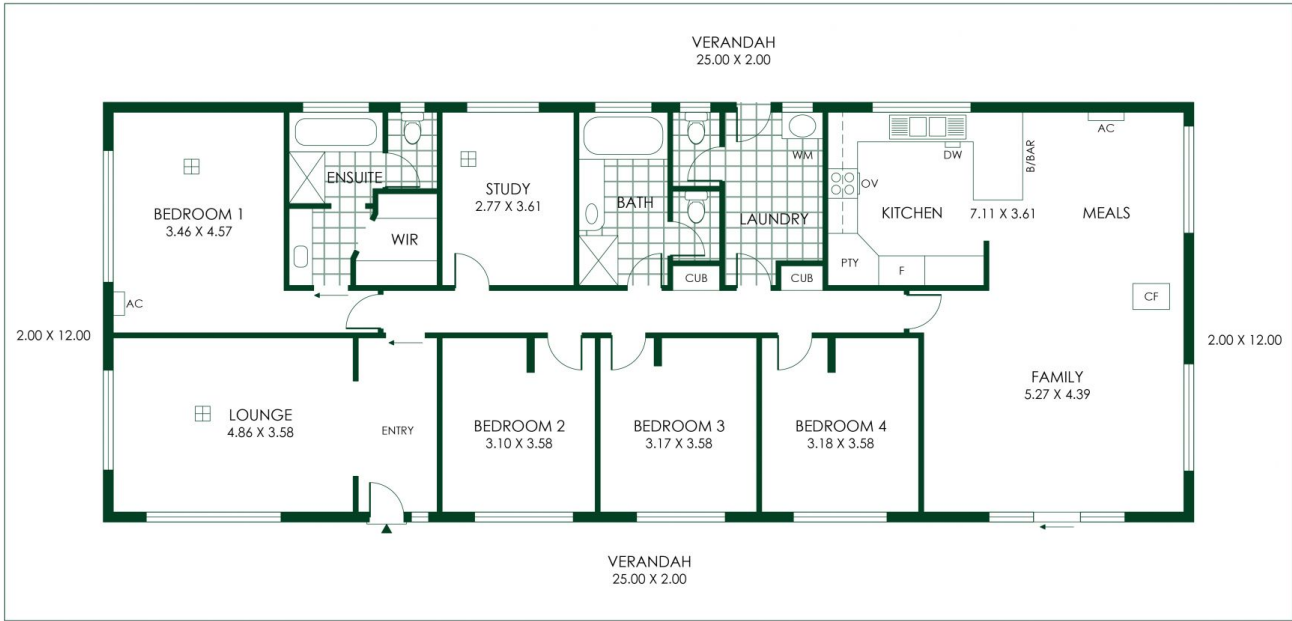

403m<sup>2</sup>

TOTAL

188m<sup>2</sup>

Living

77m<sup>2</sup>

Garage

138m<sup>2</sup>

Verandah



RWT RWT  
(NOT IN ACTUAL POSITION)

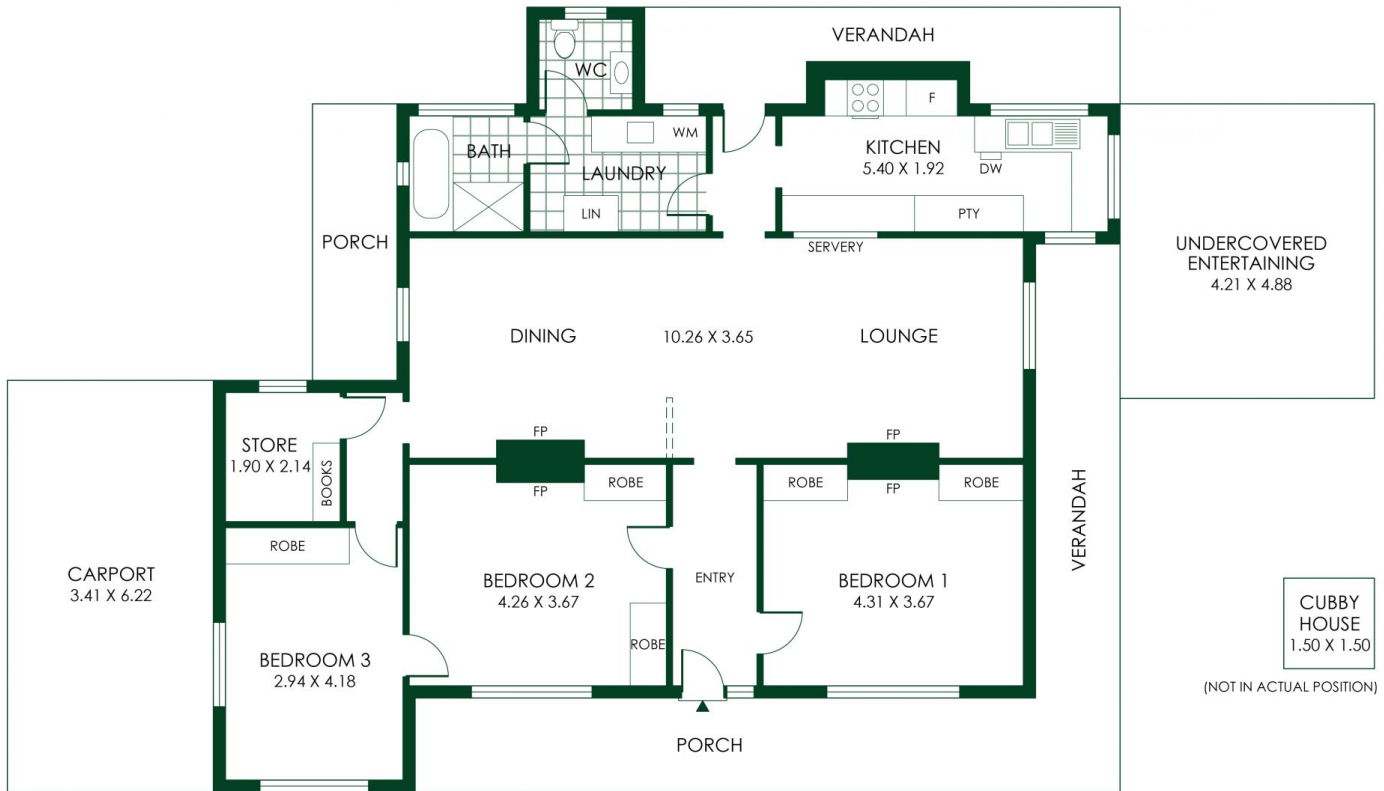

**221m<sup>2</sup>**

**TOTAL**

133m<sup>2</sup>

Living

21m<sup>2</sup>

Carport

46m<sup>2</sup>

Porch/  
Verandah

21m<sup>2</sup>

Undercovered  
Entertaining

