

# ADCOCK

R E A L E S T A T E



## 35 Mount Torrens Road Lobethal SA

3 1 2

It's one part eclectic, and every inch pretty; from the shuttered 1950s façade with town edge rural views; bring your thriving business home to commercial garage security on a verdant 1522sqm plot...

With high ceilings, timber floors, and an interior dress code to delight the entrepreneurial couple or young family, the lengths this three-bedroom, 1950s rewrite has gone to for modern-vintage appeal is also admirable.

From the wide entry foyer, flanked by two robed bedrooms, comes the hero - the sunbathed living and dining west wing, drawn to dual aspect views, decorative cornices and sparkling chandeliers.

**Type** : House  
**Price** : \$807,000  
**Land Size** : 1522 sqm  
**View** : <https://www.adcock.com.au/8559104>



**Jake Adcock**  
08 8388 4777



**Andrew Adcock**  
08 8388 4777

[For full version visit the website](#)

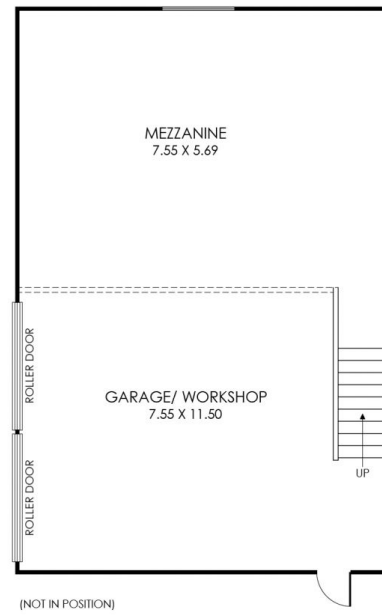

- 297m<sup>2</sup>

TOTAL
- 162m<sup>2</sup>

Living
- 1m<sup>2</sup>

Shed
- 90m<sup>2</sup>

Garage/  
Workshop
- 17m<sup>2</sup>

Porch
- 27m<sup>2</sup>

Undercover  
Entertaining



